

PLAN VIEW
NOT TO SCALE

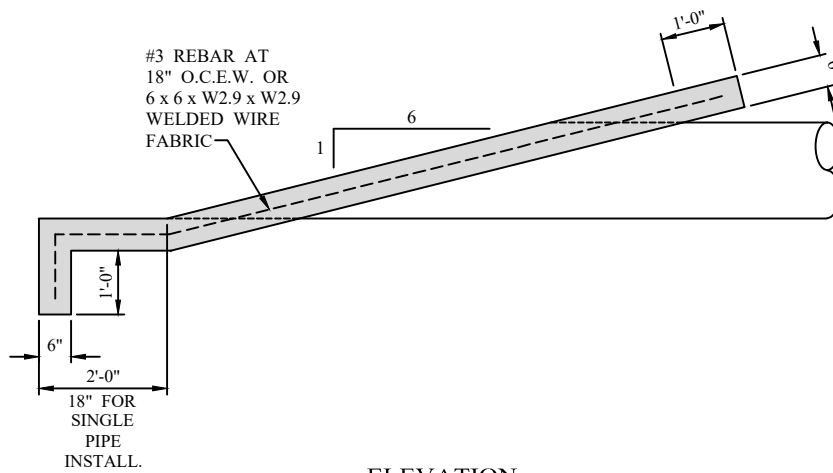

ELEVATION
NOT TO SCALE

NOTES FOR MULTIPLE INSTALLATIONS:

1. CLEAR DISTANCE BETWEEN PIPES SHALL BE A MINIMUM OF 9" FOR 12" AND 15" DIAMETERS, 14" FOR 18" DIAMETERS, AND 20" FOR 30" DIAMETERS.
2. FOR SINGLE INSTALLATIONS, A DISTANCE OF 18" IS REQUIRED FROM OUTSIDE OF PIPE TO OUTSIDE OF HEADWALL.
3. CLASS "A" CONCRETE.

CITY OF SAN ANGELO

SLOPED HEADWALL

January 2008

S-BB-1